

News Release

June. 5, 2020

Shinoken's 30th anniversary Apartment Series "Akatsuki Terrace"

Providing "Safe, Quiet and Comfortable" Living space

Today, June 5th, 2020, marks the 30th anniversary of Shinoken Group co., Ltd. (Tokyo Headquarters: Minato-ku, Tokyo, President Hideaki Shinohara, TSE Ticker 8909, further referred to as Shinoken). To commemorate this, Shinoken has launched "Akatsuki Terrace" Apartment series.

"Akatsuki Terrace", uses the word "Akatsuki" meaning "Dawn", symbolizing the Shinoken's wish for a bright future. This series delivers "safe, quiet and comfortable" living space, gathering 30 years of cultivated knowledge and experience, and setting the theme "Security" and "Technology". Shinoken is launching this as a premium model of unprecedented next generation UX (User Experience), with features of well-equipped security (such as installations of smart security cameras), facial recognition system, and improved "Shinoken Comfort Style" soundproof structure.

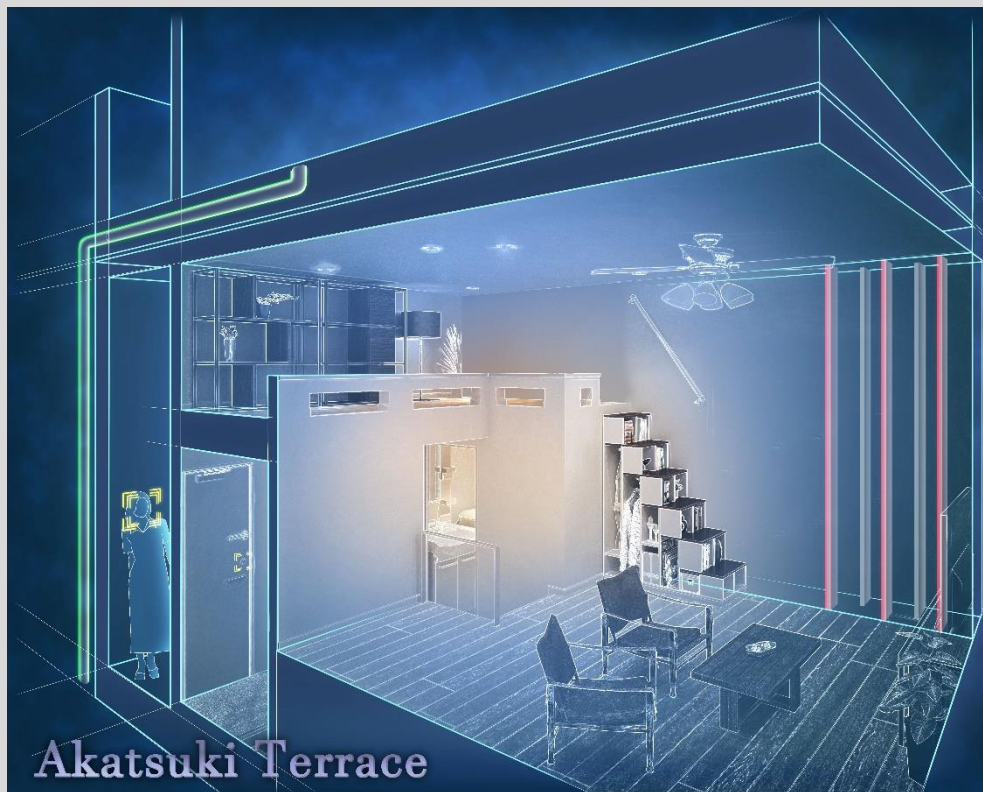

※Image

Security ~Attention drawn through the Increase of Single Residences~

With a social background of increasing single residences, the demanded safety level when living alone is increasing. In the main entrance of the “Akatsuki Terrace” series, smart security cameras are installed and linked with the property management company. Also, features such as sending a notification to the residence’s smartphone whenever there is a security breach through the door or window, and an alert system that threatens the intruder with a loud alert are equipped.

Security equipment meeting the demands of those Living Alone in Urban Areas

- Smart security cameras : Entrance Security (Linked with the PM company)
- Window security : Sending a notification when detecting a security breach
- Security Motion Detector : Detecting suspicious motions while the residence is out
- Warning alert : Threatens the intruder with a loud alert when detected

Facial Recognition Smart Lock

When the facial recognition feature is activated, it recognizes the pre-registered face to unlock the door, which comes in handy when both hands are occupied. The “Akatsuki Terrace” series employs facial recognition system at the main entrance in addition to the entrance door of each unit.

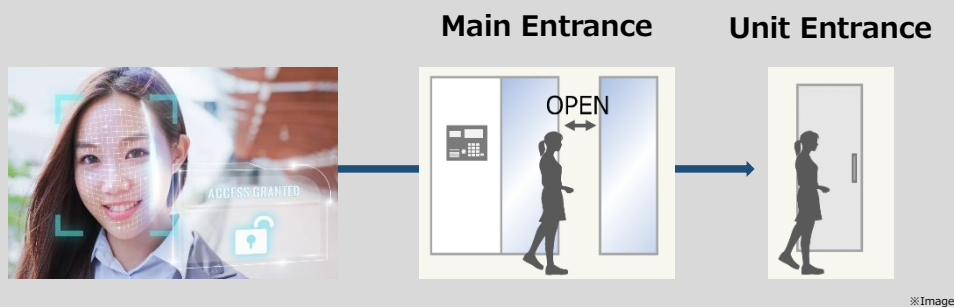

In addition to the above, features such as security signing system, call center (24hours/365days support), emergency support (※Additional fee required), etc. are available for high-standard security.

Technologies(Soundproof) ~The comfort of quietness~

Increasing telework and diversification of life style have led to spending more time at home. As a result, complaints / troubles regarding the noises from next door or above and below are generally increasing. Shinoken has fully reviewed the structure of the floor, wall, ceiling and drainage pipes and established an original soundproof “Shinoken Comfort Style”, thus improving the sound insulation ability to realize a truly comfortable living space for the residences.

“Asset development” system, especially for difficult times

Since the establishment in 1990, Shinoken has developed and provided a system where paid workers who don't own land can develop their own assets for later life, by means of Apartment management. Today, over 6,000 people own property that we developed, and over 90% of them are paid workers.

Looking ahead to the next 10 years and beyond, we will continue to create the next standard of rooms for rent, and REaaS (Real Estate as a Service), through the domestic / overseas business network and synergy effect that we established over the course of 30 years, in which we had overcome crises such as Lehman Shock.



※Image

Inquiries regarding this release

Group PR & IR Office, Shinoken Group Co., Ltd.

2-3-1, Hamamatsu-cho, Minato-ku, Tokyo

TEL +81-3-5777-0089 FAX +81-3-5777-0108

WEB <https://www.shinoken.co.jp/en/> **MAIL** skg_pr@shinoken.co.jp